

Quick-Lift Arm Torque

QLAT 350s

Intelligent lifting device which meets the highest standards of ergonomics, working environment, safety and efficiency.

Provides possibility to effortlessly handle eccentric loads.

Easy to use, thanks to outstanding responsiveness, regardless of load weight.

Exceptional safety is achieved using our intelligent control systems.

High cost efficiency through high reliability, increased productivity and long durability.

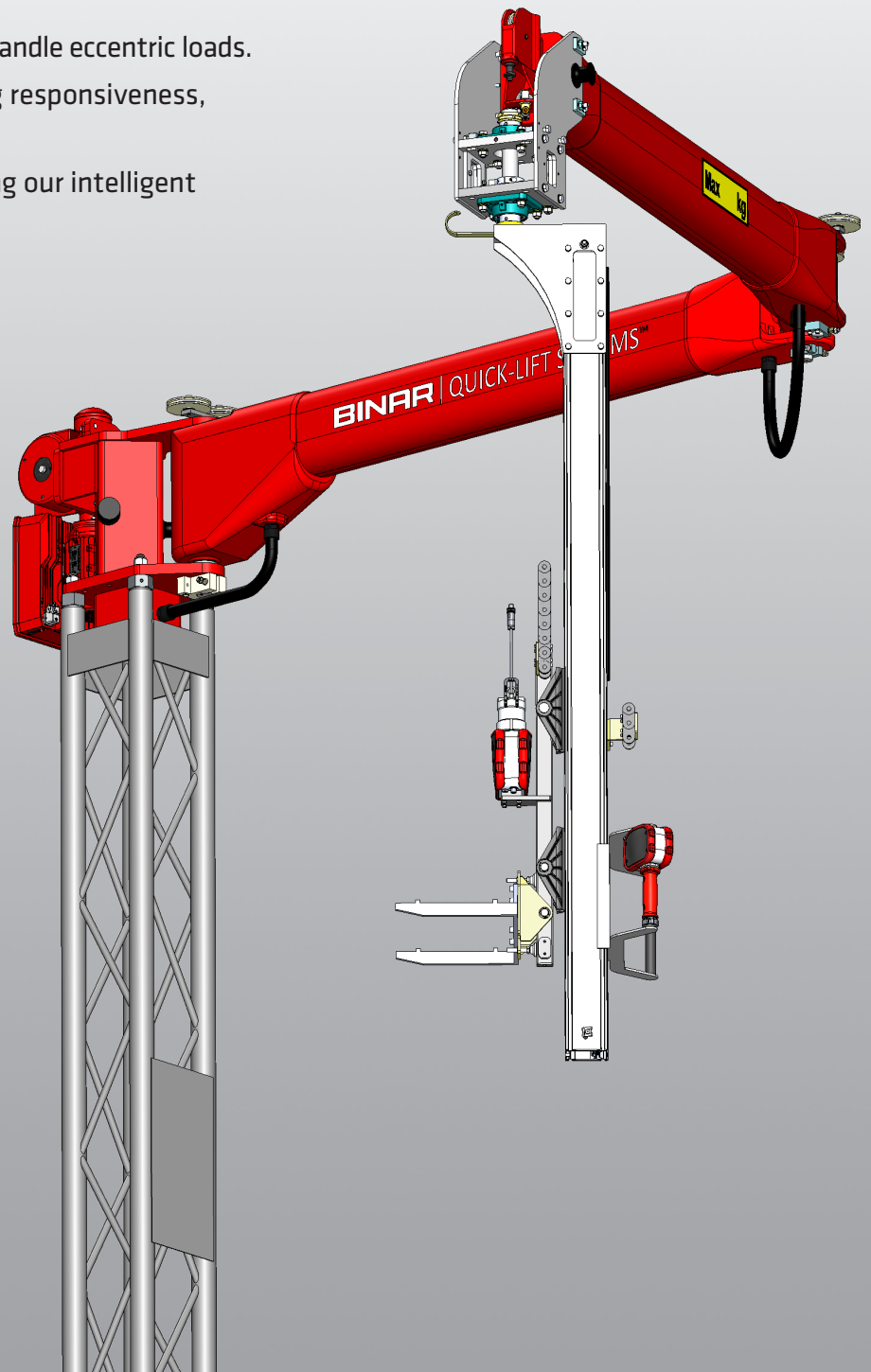

BINAR

Improving your productivity

Quick-Lift Arm Torque QLAT 350S

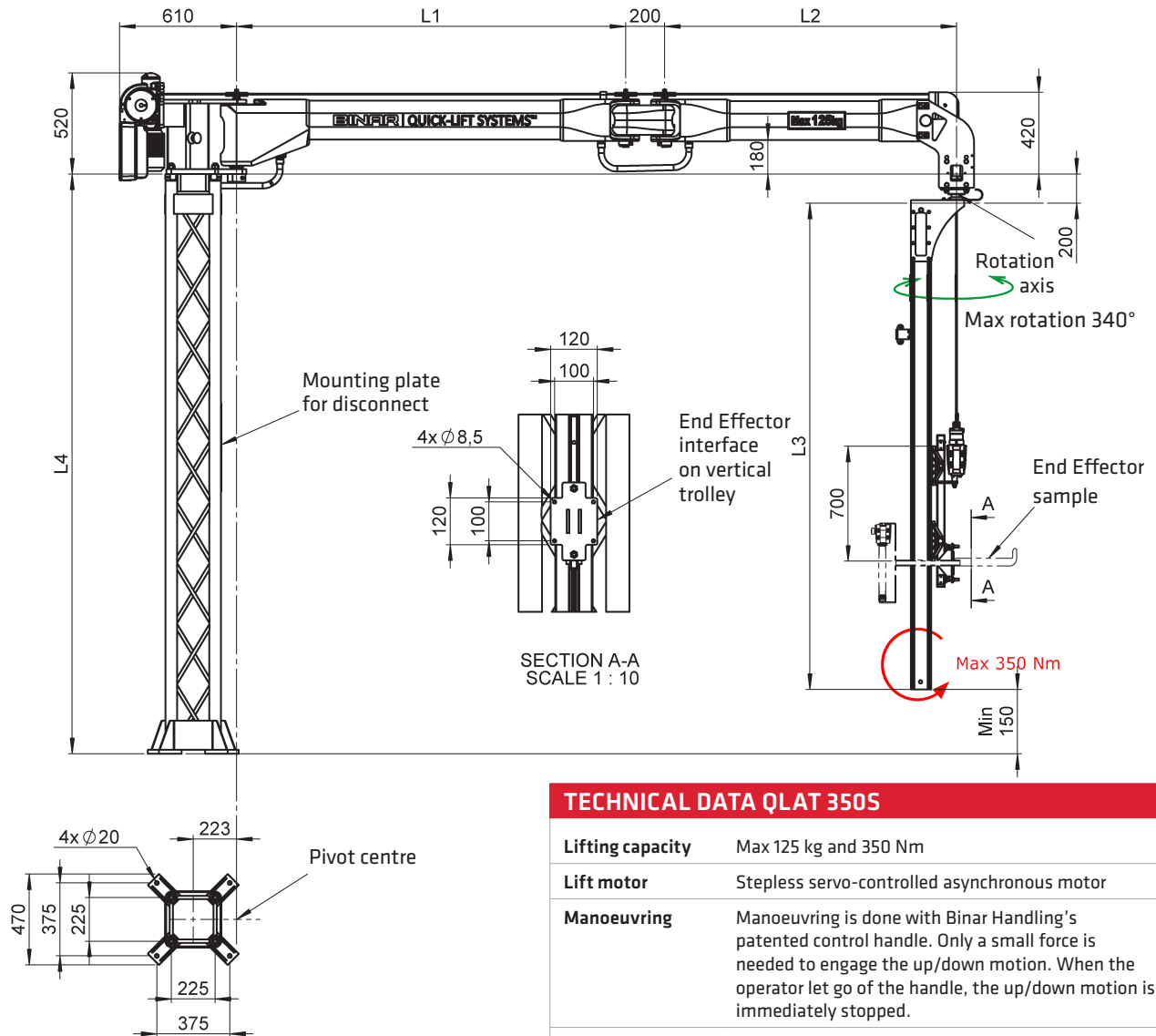

TECHNICAL DATA QLAT 350S

Lifting capacity	Max 125 kg and 350 Nm
Lift motor	Stepless servo-controlled asynchronous motor
Manoeuvring	Manoeuvring is done with Binar Handling's patented control handle. Only a small force is needed to engage the up/down motion. When the operator let go of the handle, the up/down motion is immediately stopped.
Power supply	230V, 50-60 Hz, 1-phase with ground protection, 10A
Stroke length	2,7 meter
Hinged arm	Made in painted aluminum profiles, and vertical profile in anodized aluminum.
Attachment	Floor pillar in painted steel with standard height of 3 m. Optional pillar height up to 5 m depending on customers need.
End Effector	End effectors are designed to fit customers need. Intelligent I/O signals are available for optimum functionality.
Option	Color on Arm and Motor unit, that deviates from the standard

Binar Handling AB disclaims responsibility for any errors or incomplete information in the published material and reserves the right to make changes.

Binar Handling AB

Hedekullevägen 24 • SE-461 38 TROLLHÄTTAN • Sweden
 ph +46 (0)520 47 40 00 • fax +46 (0)520 47 40 05
 e-mail info.handling@binar.se • web www.binarhandling.com

2021-01-28 EN 3.1

BINAR
 Improving your productivity